

USER MANUAL - ORIGINAL INSTRUCTIONS



AIR PURIFIER

skyled ME



MAXIMA
MADE IN ITALY



ATTENTION!



CLASS II



CE MARKING



MADE IN ITALY



INSTRUCTION



LANGUAGE

INDEX

| | |
|--|---------|
| SAFETY RULES AND PRECAUTIONS FOR USE IT..... | PAG. 03 |
| PRODUCT DESCRIPTION..... | PAG. 05 |
| MACHINE ACTIVATION..... | PAG. 05 |
| PERFUME CONTAINER..... | PAG. 05 |
| WHEN TO CLEAN THE AIR FILTER..... | PAG. 06 |
| HOW TO FIX THE BRACKET OPENLY..... | PAG. 06 |
| SOMETHING DOES NOT WORK?..... | PAG. 07 |
| SAFETY PROVISIONS AND PRECAUTIONS FOR USE..... | PAG. 08 |
| TECHNICAL FEATURES:..... | PAG. 08 |

This installation and use manual is an integral part of the product: make sure that it is always supplied with the appliance, even if it is sold to another owner. In case of loss, request a copy from the local technical service or download it directly from the company website (www.maximaitalia.com).

INTRODUCTION

CONGRATULATIONS FOR CHOOSING THIS **MADE IN ITALY** PRODUCT.

CLEAN AND HEALTHY AIR THANKS TO A COMPLETELY INNOVATIVE TECHNOLOGY. PURIFICATION WITH PHOTOCATALYTIC REACTOR, A REVOLUTION IN PURIFYING AND DEODORING THE AIR IN EVERY ROOM, HOME AND WORK.

THE TECHNOLOGY USED BY **SKYLED** ATTACKS AND DESTROYS IN A QUICK AND EFFECTIVE WAY THE MICROORGANISMS HARMFUL TO HUMANS PRESENT IN THE AIR (BACTERIA, VIRUSES, ODORS AND VOLATILE ORGANIC COMPOUNDS) EXPLOITING EXTRAORDINARY OF BIOCHEMICAL PROCESSES.



ATTENTION: DO NOT USE THE APPLIANCE WITHOUT READING THE MANUAL.

IMPORTANT: Always follow the instructions and guidelines contained therein in this manual. Use the appliance only in the mode described in this manual.

GENERAL INSTRUCTIONS REGARDING SAFETY

- Do not activate if the cord or plug is damaged.
- Do not handle with wet hands. Dry your hands before handle the air purifier.
- Do not immerse the air purifier in water or other liquids.
- Do not use the air purifier in wet or humid environments.
- Do not use the air purifier outdoors.
- Do not use the air purifier in rooms where there are large changes in temperature. This could cause training of condensation inside the appliance.
- This appliance is designed for use in commercial areas.
- Do not use or store flammable or combustible substances such as ether, benzene, alcohol, chemicals, LPG, fuel sprays, insecticides, air fresheners, cosmetics, candles or lamps near the appliance.
- If you use the air purifier in places where it comes from given oxygen, ensures that the purifier distances at least 1.5 meters away from the oxygen cylinder.
- Do not place the product under carpets, rugs or blankets.
- Do not move the product when it is in operation.
- Do not insert your fingers or objects into the air exhaust.
- Do not let children play with or on the purifier of the air. It is necessary to supervise children when the purifier is on.
- The appliance can be used by children of no less than age at 8 years old and by people with reduced physical, sensory or mental, or lacking experience or the necessary knowledge, as long as they are under surveillance or after they have received instructions on the safe use of the device and the understanding of the dangers inherent to it.
- Cleaning and maintenance intended to be carried out by the user must not be carried out by children.

- Place the air purifier on a flat, solid surface before operation.
- For wall fixing, use suitable plugs.
- Do not place the air purifier near heat sources, such as open flames, stoves, ovens, radiators or computers.
- Do not run the cord under carpets, rugs, furniture or domestic appliances. Place the power cord away from areas of intense traffic.
- Do not allow pets or puppies to chew the power cord.
- Do not sit or place anything on top of the air purifier.
- Do not place the air purifier directly under a air conditioner, to prevent moisture from entering the air purifier.
- Be careful not to pinch your fingers when removing or remove the filters.
- Do not use the product if it is damaged or disassembled.
- Disconnect the power supply before carrying out the filter maintenance and replacement.
- Do not clean the appliance with water or any other liquid for avoid electric shock, fire or injury.
- Disconnect the power cord immediately if the product generates smoke or unusual odors or noises and contact the Customer Assistance Service.
- Do not try to repair this appliance in any way either use third party spare parts to modify the purifier of the air. Doing so will void the warranty. Contact the Customer Service Department immediately in the event that your appliance no longer works.

The manufacturer declines all responsibility in the event of a failure or damage as a result of improper use or maintenance.

STORE THESE INSTRUCTIONS



1. Cap
2. Perfume container
3. Air outlet
4. Stainless steel outer shell
5. 2-speed touch power button
6. Power connector
7. Air intake

MACHINE ACTIVATION

- Place the air purifier on a flat surface.
- Connect the air purifier to a 12 Vdc power supply
- Touch button (5) to turn on the air purifier.
- To select the higher ventilation speed, press the button (5) a second time.
- To turn off the air purifier, press the button (5) for the third time.

PERFUME CONTAINER



- Turn off the air purifier.
- Remove the cap. (2)
- Pour a few drops of perfume (maximum 10) into the central cup using a special dispenser. (8)
- Put the cap back on.

ATTENTION!:

PUT THE PERFUME ONLY IN THE CENTRAL CONTAINER, DO NOT POUR IT DIRECTLY INTO THE WADDING. DO NOT SPILL THE PERFUME OUTSIDE THE CONTAINER, IT MAY DAMAGE THE PAINT. DO NOT POUR THE PERFUME INTO THE AIR OUTLET SLOTS, THIS COULD CAUSE ELECTRICAL DAMAGE.



USE WATER BASED PERFUMES ONLY, DO NOT USE ESSENTIAL OILS.

WHEN TO CLEAN THE AIR FILTER

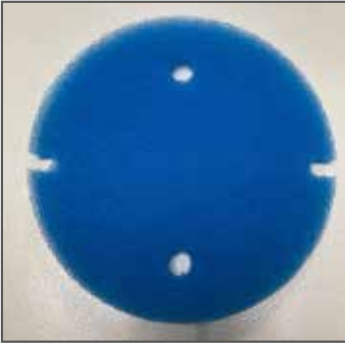

- Even the room where you use the air purifier may extend or shorten the air filter life. If you use the air purifier in a polluted environment, you should change the air filter more often.
- If the air pollution in your environment is very high, there is a possibility that the filter is not fully effective and must be replaced.

IMPORTANT: ONLY USE ORIGINAL FILTERS; DIFFERENT FILTERS MAY AFFECT THE DEVICE EFFICIENCY AND/OR CAUSE FAULTS.

CLEANING THE AIR FILTER



fig. a

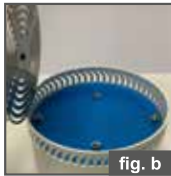

fig. b

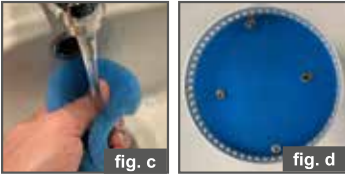

fig. c

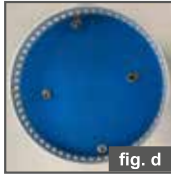

fig. d

1. Turn off the purifier and disconnect the plug power supply, then place it on a flat and stable surface (fig.a)
2. Unscrew the two nuts counterclockwise under the support base. (fig.a).
3. Remove the base by sliding it off (fig.b).
4. Remove the air filter and wash it with water.
5. Clean any residual dust with a cloth inside the housing.
6. Reposition the air filter once dry (fig.d).
7. Put back the support base and screw the nuts.
8. Turn the air purifier always resting it with the base on a flat and stable surface.



IMPORTANT: WE RECOMMEND TO USE ONLY ORIGINAL FILTERS, DIFFERENT FILTERS COULD CHANGE THE EFFICIENCY OF THE APPLIANCE AND / OR CAUSE IT TO MALFUNCTION.

HOW TO FIX THE BRACKET OPENLY



fig. a



fig. b

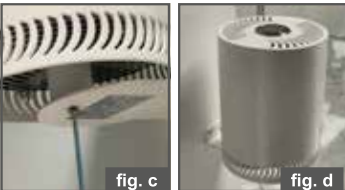

fig. c



fig. d

1. Turn off and disconnect the power supply plug of the air purifier, then turn it upside down resting it on a stable flat surface (fig.a).
2. Unscrew the central screw counterclockwise under the support base (fig.a).
3. Remove the base, and fix it to a wall with suitable plugs and screws (fig.b)
4. Fix the purifier to the support base by screwing it on the decentralized hole (fig. C - d).

SOMETHING DOES NOT WORK?

EN

Sometimes it depends on causes that can be easily eliminated by doing simple checks.

| ANOMALY | CAUSE | SOLUTION |
|--|---|--|
| The purifier does not turn on. | The unit is not connected to an electrical outlet. | Connect the plug to a socket electric powered. |
| | The power outlet does not work well. | Try connecting the purifier to a different outlet. |
| | The power cord is damaged. | Stop using it immediately and replace the cable. |
| | The air purifier is defective or malfunctioning. | Stop using it immediately and contact your Dealer or Service Center. |
| The purifier emits an unusual noise in function. | Inside the unit there is an object stranger. | Stop using it immediately and contact the Reseller or the Center of Assistance. DO NOT try to open the purifier. |
| Air flux greatly reduced. | The filter must be CLEAN. | Clean the air filter (see page 6). |
| | Velocità ventilatore bassa. | Increase the fan speed, (see page 5) |
| Poor quality of purified air. | Air inlet blocked. | Remove the blocking objects the air inlet or outlet. |
| | The air filter is dirty e it can no longer produce air fresh. | Clean the air filter. |

If after these checks the machine does not work, please contact the Dealer or the Service Center.



TECHNICAL FEATURES:

| | |
|---|--|
| Power supply | 12 Vdc - 1,34 A |
| Adapter | 100-240 Vac - 50/60 Hz |
| Consumption | Max 16 W |
| Fan power | 23 m ³ /h x 2 |
| Operating conditions | Temperature: +3 °C / +55 °C - Humidity: +/- 95% RH |
| Volume of filtered air | +/- 20 m ³ /h |
| Sanitizing technology | Photocatalytic reactor (UV LED + TiO ₂) |
| UV led duration | Over 10 years with 16 hours / day operation |
| Protective filter | Washable |
| Structure | Stainless Steel |
| Net weight | 1,95 Kg |
| Skyled dimensions | Structure Ø 126 mm - h 175 mm |
| The A-weighted emission sound pressure level in workstations does not exceed 70dB (A) | |

For any malfunction, please contact your dealer or the Technical Service. Never repair your device on your own. The regulations at the basis of its manufacture might break and consequently the warranty might forfeit. The warranty forfeits also when any intervention is carried out by non-authorized staff.

CONDITIONS

The device sold is guaranteed according to the Law for possible manufacture failures. During this period, the faulty components are replaced free, if the failure is not caused by collisions, falls, fires, short circuits or by an improper use. The non-working device or the faulty parts are to be sent carriage free to our Company or to the authorised Technical Service. We send the repaired components back carriage paid to the purchaser address.

INFORMATION FOR THE USERS ON THE DISPOSAL OF OUTDATED ELECTRIC AND ELECTRONIC DEVICES (FOR PRIVATE FAMILY UNIT)

This symbol on the products and/or on the documents means that the electric and electronic products used are not to be disposed of with generic household waste. For a correct treatment, reutilization and recycling take these products to the collecting points, where they are accepted free. Alternatively, in some Countries the products could be given back to the local dealer when purchasing another equivalent product. A correct disposal of this product will allow saving precious resources and avoid possible negative effects on the human health and on the environment. For further details, contact the local authority or the nearest collecting point. In case of wrong disposal, penalties may be applied according to the Local Law. For the Companies of the European Union: if you wish to dispose of electric and electronic devices, contact the dealer or the supplier for further details. Information about disposal in Countries not belonging to the European Union. This symbol is valid only in the European Union. If the device should be disposed of, contact the local authority or the dealer and ask for information about a correct disposal.



USER MANUAL - ORIGINAL INSTRUCTIONS



AIR PURIFIER

skyled M



MAXIMA
MADE IN ITALY



INDEX

| | |
|--|---------|
| SAFETY RULES AND PRECAUTIONS FOR USE IT..... | PAG. 03 |
| PRODUCT DESCRIPTION..... | PAG. 05 |
| MACHINE ACTIVATION..... | PAG. 05 |
| WHEN TO CLEAN THE AIR FILTER..... | PAG. 06 |
| HOW TO FIX THE BRACKET OPENLY..... | PAG. 06 |
| SOMETHING DOES NOT WORK?..... | PAG. 07 |
| SAFETY PROVISIONS AND PRECAUTIONS FOR USE..... | PAG. 08 |
| TECHNICAL FEATURES:..... | PAG. 08 |

This installation and use manual is an integral part of the product: make sure that it is always supplied with the appliance, even if it is sold to another owner. In case of loss, request a copy from the local technical service or download it directly from the company website (www.maximaitalia.com).

INTRODUCTION

CONGRATULATIONS FOR CHOOSING THIS **MADE IN ITALY** PRODUCT.

CLEAN AND HEALTHY AIR THANKS TO A COMPLETELY INNOVATIVE TECHNOLOGY. PURIFICATION WITH PHOTOCATALYTIC REACTOR, A REVOLUTION IN PURIFYING AND DEODORING THE AIR IN EVERY ROOM, HOME AND WORK.

THE TECHNOLOGY USED BY **SKYLED** ATTACKS AND DESTROYS IN A QUICK AND EFFECTIVE WAY THE MICROORGANISMS HARMFUL TO HUMANS PRESENT IN THE AIR (BACTERIA, VIRUSES, ODORS AND VOLATILE ORGANIC COMPOUNDS) EXPLOITING EXTRAORDINARY OF BIOCHEMICAL PROCESSES.



ATTENTION: DO NOT USE THE APPLIANCE WITHOUT READING THE MANUAL.

IMPORTANT: Always follow the instructions and guidelines contained therein in this manual. Use the appliance only in the mode described in this manual.

GENERAL INSTRUCTIONS REGARDING SAFETY

- Do not activate if the cord or plug is damaged.
- Do not handle with wet hands. Dry your hands before handle the air purifier.
- Do not immerse the air purifier in water or other liquids.
- Do not use the air purifier in wet or humid environments.
- Do not use the air purifier outdoors.
- Do not use the air purifier in rooms where there are large changes in temperature. This could cause training of condensation inside the appliance.
- This appliance is designed for use in commercial areas.
- Do not use or store flammable or combustible substances such as ether, benzene, alcohol, chemicals, LPG, fuel sprays, insecticides, air fresheners, cosmetics, candles or lamps near the appliance.
- If you use the air purifier in places where it comes from given oxygen, ensures that the purifier distances at least 1.5 meters away from the oxygen cylinder.
- Do not place the product under carpets, rugs or blankets.
- Do not move the product when it is in operation.
- Do not insert your fingers or objects into the air exhaust.
- Do not let children play with or on the purifier of the air. It is necessary to supervise children when the purifier is on.
- The appliance can be used by children of no less than age at 8 years old and by people with reduced physical, sensory or mental, or lacking experience or the necessary knowledge, as long as they are under surveillance or after they have received instructions on the safe use of the device and the understanding of the dangers inherent to it.
- Cleaning and maintenance intended to be carried out by the user must not be carried out by children.

- Place the air purifier on a flat, solid surface before operation.
- For wall fixing, use suitable plugs.
- Do not place the air purifier near heat sources, such as open flames, stoves, ovens, radiators or computers.
- Do not run the cord under carpets, rugs, furniture or domestic appliances. Place the power cord away from areas of intense traffic.
- Do not allow pets or puppies to chew the power cord.
- Do not sit or place anything on top of the air purifier.
- Do not place the air purifier directly under a air conditioner, to prevent moisture from entering the air purifier.
- Be careful not to pinch your fingers when removing or remove the filters.
- Do not use the product if it is damaged or disassembled.
- Disconnect the power supply before carrying out the filter maintenance and replacement.
- Do not clean the appliance with water or any other liquid for avoid electric shock, fire or injury.
- Disconnect the power cord immediately if the product generates smoke or unusual odors or noises and contact the Customer Assistance Service.
- Do not try to repair this appliance in any way either use third party spare parts to modify the purifier of the air. Doing so will void the warranty. Contact the Customer Service Department immediately in the event that your appliance no longer works.

The manufacturer declines all responsibility in the event of a failure or damage as a result of improper use or maintenance.

STORE THESE INSTRUCTIONS



1. Air outlet
2. Stainless steel outer shell
3. 2-speed touch power button
4. Power connector
5. Air intake

MACHINE ACTIVATION

- Place the air purifier on a flat surface.
- Connect the air purifier to a 12 Vdc power supply
- Touch button (3) to turn on the air purifier.
- To select the higher ventilation speed, press the button (3) a second time.
- To turn off the air purifier, press the button (3) for the third time.



WHEN TO CLEAN THE AIR FILTER

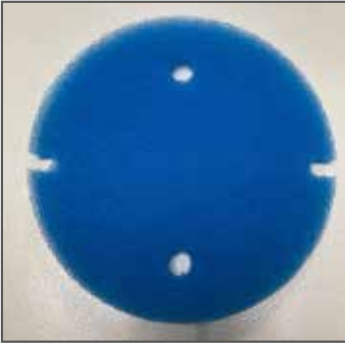

- Even the room where you use the air purifier may extend or shorten the air filter life. If you use the air purifier in a polluted environment, you should change the air filter more often.
- If the air pollution in your environment is very high, there is a possibility that the filter is not fully effective and must be replaced.

IMPORTANT: ONLY USE ORIGINAL FILTERS; DIFFERENT FILTERS MAY AFFECT THE DEVICE EFFICIENCY AND/OR CAUSE FAULTS.

CLEANING THE AIR FILTER



fig. a

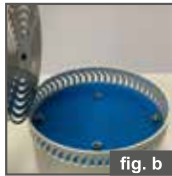

fig. b

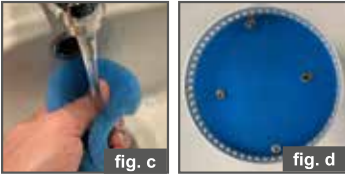

fig. c

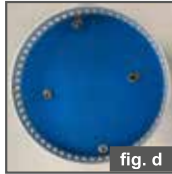

fig. d

1. Turn off the purifier and disconnect the plug power supply, then place it on a flat and stable surface (fig.a)
2. Unscrew the two nuts counterclockwise under the support base. (fig.a).
3. Remove the base by sliding it off (fig.b).
4. Remove the air filter and wash it with water.
5. Clean any residual dust with a cloth inside the housing.
6. Reposition the air filter once dry (fig.d).
7. Put back the support base and screw the nuts.
8. Turn the air purifier always resting it with the base on a flat and stable surface.



IMPORTANT: WE RECOMMEND TO USE ONLY ORIGINAL FILTERS, DIFFERENT FILTERS COULD CHANGE THE EFFICIENCY OF THE APPLIANCE AND / OR CAUSE IT TO MALFUNCTION.

HOW TO FIX THE BRACKET OPENLY



fig. a



fig. b

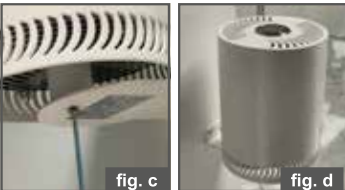

fig. c



fig. d

1. Turn off and disconnect the power supply plug of the air purifier, then turn it upside down resting it on a stable flat surface (fig.a).
2. Unscrew the central screw counterclockwise under the support base (fig.a).
3. Remove the base, and fix it to a wall with suitable plugs and screws (fig.b)
4. Fix the purifier to the support base by screwing it on the decentralized hole (fig. C - d).

SOMETHING DOES NOT WORK?

EN

Sometimes it depends on causes that can be easily eliminated by doing simple checks.

| ANOMALY | CAUSE | SOLUTION |
|--|---|--|
| The purifier does not turn on. | The unit is not connected to an electrical outlet. | Connect the plug to a socket electric powered. |
| | The power outlet does not work well. | Try connecting the purifier to a different outlet. |
| | The power cord is damaged. | Stop using it immediately and replace the cable. |
| | The air purifier is defective or malfunctioning. | Stop using it immediately and contact your Dealer or Service Center. |
| The purifier emits an unusual noise in function. | Inside the unit there is an object stranger. | Stop using it immediately and contact the Reseller or the Center of Assistance. DO NOT try to open the purifier. |
| Air flux greatly reduced. | The filter must be CLEAN. | Clean the air filter (see page 6). |
| | Velocità ventilatore bassa. | Increase the fan speed, (see page 5) |
| Poor quality of purified air. | Air inlet blocked. | Remove the blocking objects the air inlet or outlet. |
| | The air filter is dirty e it can no longer produce air fresh. | Clean the air filter. |

If after these checks the machine does not work, please contact the Dealer or the Service Center.



TECHNICAL FEATURES:

| | |
|---|--|
| Power supply | 12 Vdc - 1,34 A |
| Adapter | 100-240 Vac - 50/60 Hz |
| Consumption | Max 16 W |
| Fan power | 23 m³/h x 2 |
| Operating conditions | Temperature: +3 °C / +55 °C - Humidity: +/- 95% RH |
| Volume of filtered air | +/- 20 m³/h |
| Sanitizing technology | Photocatalytic reactor (UV LED + TiO ₂) |
| UV led duration | Over 10 years with 16 hours / day operation |
| Protective filter | Washable |
| Structure | Stainless Steel |
| Net weight | 1,95 Kg |
| Skyled dimensions | Structure Ø 126 mm - h 175 mm |
| The A-weighted emission sound pressure level in workstations does not exceed 70dB (A) | |

For any malfunction, please contact your dealer or the Technical Service. Never repair your device on your own. The regulations at the basis of its manufacture might break and consequently the warranty might forfeit. The warranty forfeits also when any intervention is carried out by non-authorized staff.

CONDITIONS

The device sold is guaranteed according to the Law for possible manufacture failures. During this period, the faulty components are replaced free, if the failure is not caused by collisions, falls, fires, short circuits or by an improper use. The non-working device or the faulty parts are to be sent carriage free to our Company or to the authorised Technical Service. We send the repaired components back carriage paid to the purchaser address.

INFORMATION FOR THE USERS ON THE DISPOSAL OF OUTDATED ELECTRIC AND ELECTRONIC DEVICES (FOR PRIVATE FAMILY UNIT)

This symbol on the products and/or on the documents means that the electric and electronic products used are not to be disposed of with generic household waste. For a correct treatment, reutilization and recycling take these products to the collecting points, where they are accepted free. Alternatively, in some Countries the products could be given back to the local dealer when purchasing another equivalent product. A correct disposal of this product will allow saving precious resources and avoid possible negative effects on the human health and on the environment. For further details, contact the local authority or the nearest collecting point. In case of wrong disposal, penalties may be applied according to the Local Law. For the Companies of the European Union: if you wish to dispose of electric and electronic devices, contact the dealer or the supplier for further details. Information about disposal in Countries not belonging to the European Union. This symbol is valid only in the European Union. If the device should be disposed of, contact the local authority or the dealer and ask for information about a correct disposal.

